

# SUTT/SUTTA/SUTTH series CENTER TYPE TAILSTOCK

**Manual Type**  
SUTT-125/170/210/255/320/400

**Pneumatic / Hydraulic Type**  
SUTTA(H)-125/170/210/255/320/400

- The tailstock is ruggedly constructed for high rigidity.
- For models over 125, #MT4 center is used. #400 MT5.
- The mini type 125S is suitable for small type machine tools for light cutting applications.



^ SUTT-125

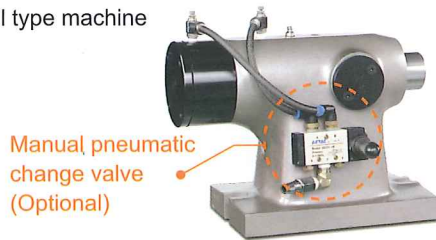

^ SUTTA-255



^ SUTTH-320

## Dimensional Drawings:

### SUTT

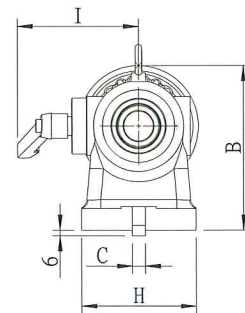
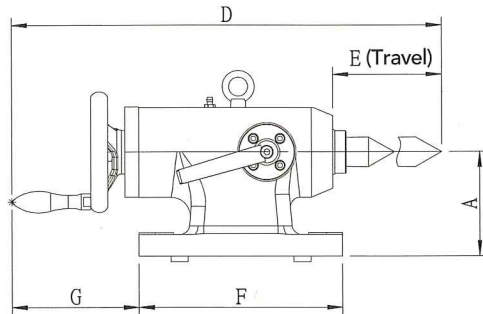

Unit: mm

Model / Specif.	A	B	C	D	E	F	G	H	I	CENTER (Morse)
SUTT-125S	110	140.5	14	294/324	30	140	137.5	80	105.5	#MT2
SUTT-125	110	157	14	405/455	50	215	134.5	122	128	#MT4
SUTT-170	135	182	18	405/455	50	215	134.5	122	128	#MT4
SUTT-210	160	207	18	405/455	50	215	134.5	122	128	#MT4
SUTT-255	160	207	18	405/455	50	215	134.5	122	128	#MT4
SUTT-320	210	257	18	405/455	50	215	134.5	122	128	#MT4
SUTT-400	255	302	18	461/521	60	270	134.5	160	141	#MT5

## Dimensional Drawings:

### SUTTA SUTTH

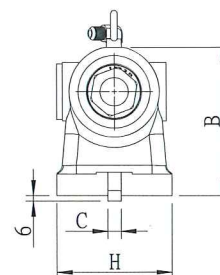
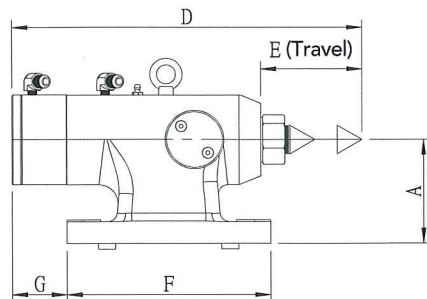

Unit: mm

Model / Specif.	A	B	C	D	E	F	G	H	CENTER (Morse)
SUTTA/H-125S	110	140.5	14	215.2/245.2	30	140	58	80	#MT2
SUTTA/H-125	110	157	14	320/370	50	215	59	122	#MT4
SUTTA/H-170	135	182	18	320/370	50	215	58	122	#MT4
SUTTA/H-210	160	207	18	320/370	50	215	58	122	#MT4
SUTTA/H-255	160	207	18	320/370	50	215	58	122	#MT4
SUTTA/H-320	210	257	18	320/370	50	215	58	122	#MT4
SUTTA/H-400	255	308	18	442/502	60	270	120	160	#MT5

\* PAINTING COLOR: Choice of shining silver or yellow color.