



MULTI-POWER CNC SUPER VISE

Significantly upgrade CNC Machining Centers



PATENTED
M458489
M395751
M278511
M390838
M435335

- Shortest Length with Big Jaw Opening
- Extremely High Accuracy and Repeatability
- Special MULTI-POWER design enhances clamping force of **0~8000 KG**
- Suitable for Gantry-Type machining center

PATENTED
M458489
M395751
M278511
M390838
M435335

MULTI-POWER CNC SUPER VISE

Model: HPAQ - 160, 200, 250, 160L, 200L

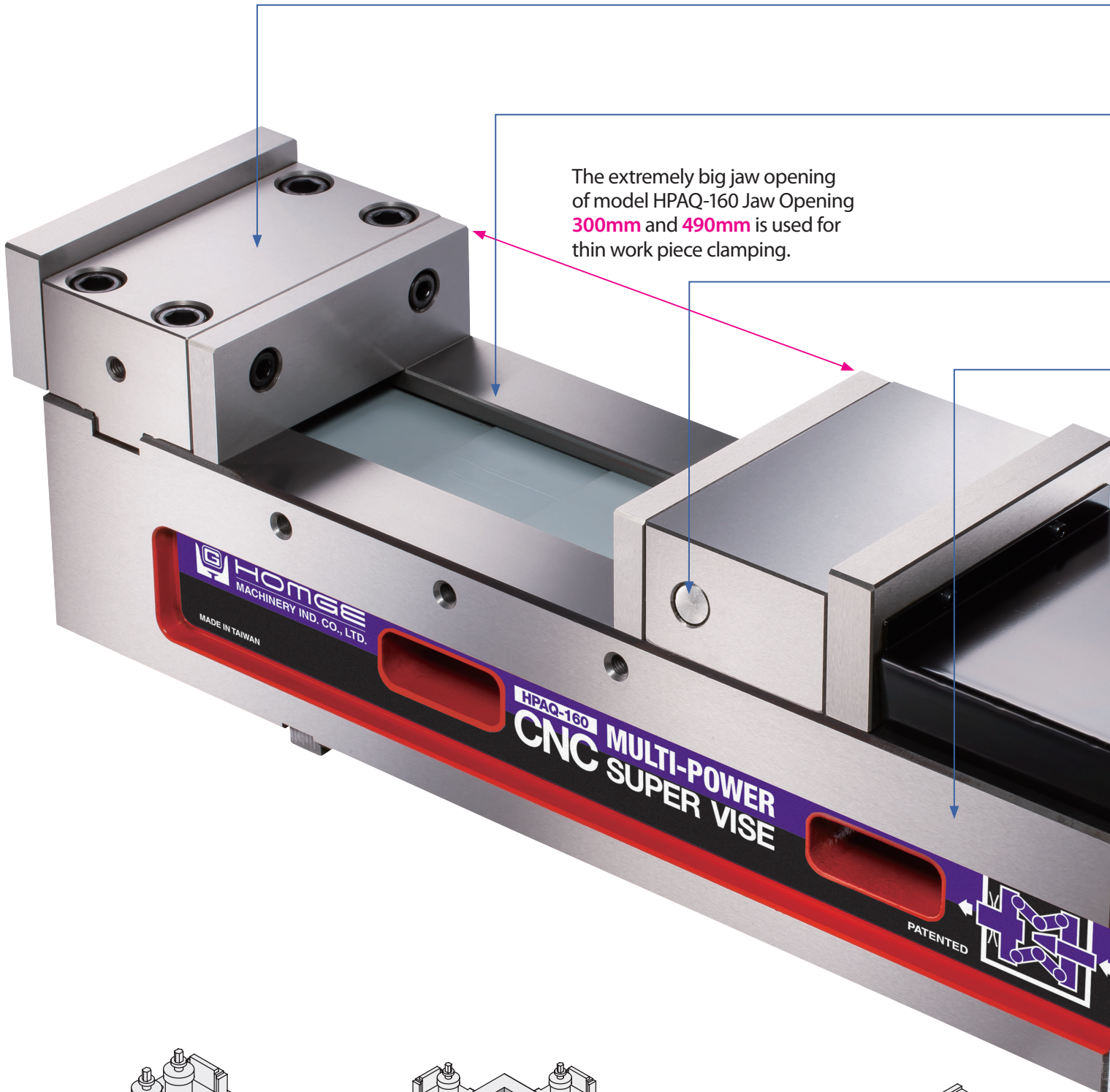

The extremely big jaw opening of model HPAQ-160 Jaw Opening 300mm and 490mm is used for thin work piece clamping.

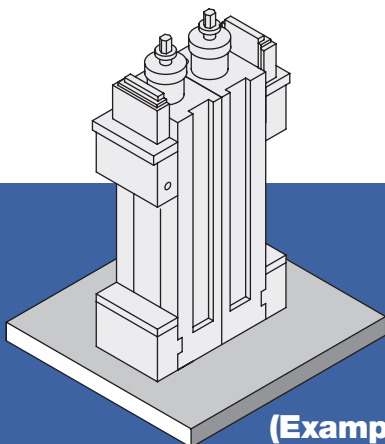

(Example 1)

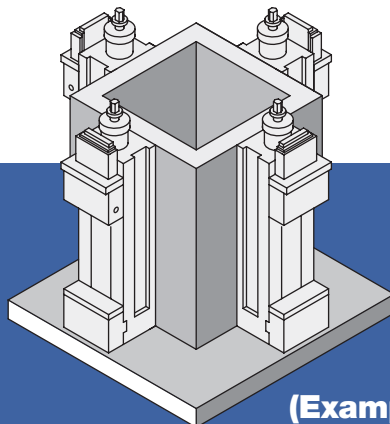

(Example 2)

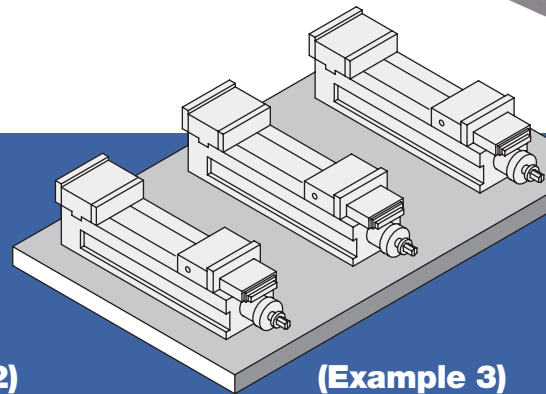

(Example 3)

1. **Vise Fixed Jaw** is made by **high quality steel** and **HARDENED** to **HRC 55°**. Vise body is made of Ductile Iron above FCD 60 grade for high precision and durability. With a force of 4500kg, the shape will deflect less than **0.005mm**.

2. Slide ways are **HARDENED** to **HRC 50°** to further increase durability and maintain positioning height over long use.

3. The **Special ANGLE-LOCK SYSTEM** with compact design and high-grade iron of over FCD 60 grade for high rigidity automatically pulls the work-piece down to the accurate position of within **0.005mm** under 4500kg of pressure. This vise is most suitable for precision mould making on Machining Centers.

4. Vise can be mounted horizontally or vertically.

5. The patented MULTI-POWER SYSTEM built of **HIGH GRADE BEARING STEEL** doubles the clamping force. With the **first half a turn** the vise will clamp with **2500kg** pressure. With **a second half turn** it will apply **4500kg** of clamping force. This special patented system makes the clamping force constant.

6. **Adjusting stop ring:** this simple and effective presetting device enables to **preset each desired clamping force** and it guarantees to repeat each clamping operation at the same clamping force.

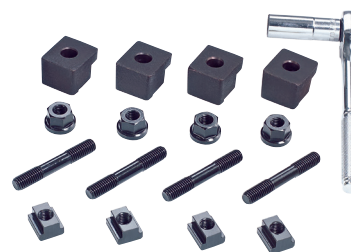

STANDARD ACCESSORIES:

- 2 pcs of Alignment Wedge
- 4 pcs of Clamp
- 1 pc of Handle

OPTIONAL ACCESSORIES

- Cross Grooved Jaws
- "V" Jaws
- Combined Jaws
- Step Jaws



The patented MULTI-POWER SYSTEM built of **HIGH GRADE BEARING STEEL** provides extremely high clamping pressure. The pressure is more consistent and eliminates all leakage and maintenance problems associated with Hydraulic Vises.

Fixed height so several vises can be used together.

This vise is highly suitable for precision mould making on machining centers as well as heavy duty machining which required high clamping force with high accuracy.

PATENTED
M 523545
M 278511

MULTI-POWER CNC SUPER VISE

Model: HPAQ - 100, 130



- Shortest Length with Big Jaw Opening
- Extremely High Accuracy and Repeatability
- Special MULTI-POWER design enhances clamping force of **0~5500 KG**

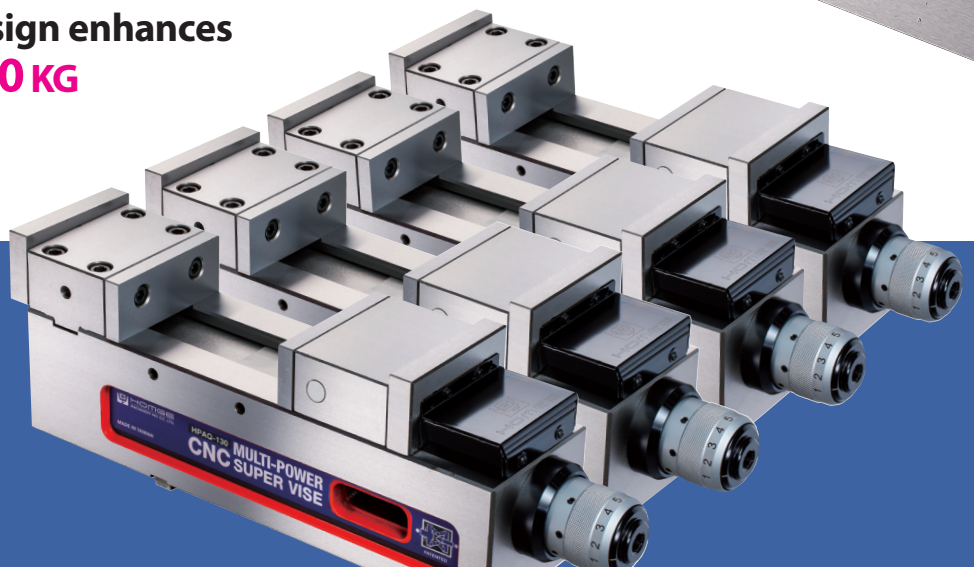

1. **Vise Fixed Jaw** is made by **high quality steel** and **HARDENED to HRC 55°**. Vise body is made of Ductile Iron above FCD 60 grade for high precision and durability. With a force of 2500kg, the shape will deflect less than **0.005mm**.
2. Slide ways are **HARDENED to HRC 50°** to further increase durability and maintain positioning height over long use.
3. The **Special ANGLE-LOCK SYSTEM** with compact design and high-grade iron of over FCD 60 grade for high rigidity automatically pulls the work-piece down to the accurate position of within **0.005mm** under 2500kg of pressure. This vise is most suitable for precision mould making on Machining Centers.
4. Vise can be mounted horizontally or vertically.
5. The patented MULTI-POWER SYSTEM built of **HIGH GRADE BEARING STEEL** doubles the clamping force. **This special patented system makes the clamping force constant.**

6. **Adjusting stop ring:** this simple and effective presetting device enables to **preset each desired clamping force** and it guarantees to repeat each clamping operation at the same clamping force.



Clamping force

- 1000 kg
- 2000 kg
- 3000 kg
- 4000 kg
- 5000 kg

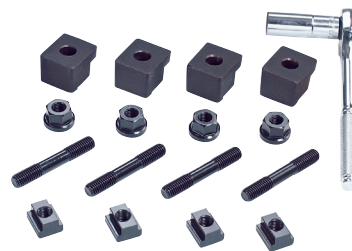

STANDARD ACCESSORIES:

- 2 pcs of Alignment Wedge
- 4 pcs of Clamp
- 1 pc of Handle

OPTIONAL ACCESSORIES

- Cross Grooved Jaws
- "V" Jaws
- Combined Jaws
- Step Jaws



PAT.

The patented MULTI-POWER SYSTEM built of **HIGH GRADE BEARING STEEL** provides extremely high clamping pressure. The pressure is more consistent and eliminates all leakage and maintenance problems associated with Hydraulic Vises.

Fixed height so several vises can be used together. This vise is highly suitable for precision mould making on machining centers as well as heavy duty machining which required high clamping force with high accuracy.

MULTI-POWER CNC SUPER VISE (Front-Mounting Type)

PATENTED
M278511
M458489
M435335
M397304
I373394

Model: HPAQ-II-160F

- Special MULTI-POWER design enhances clamping force of **0~5000kg**
- It's **ergonomics** for easy reach, thus saves time and prevents back strain
- It possesses all features of HPAQ-Type



STANDARD ACCESSORIES:

- 2 pcs of Alignment Wedge
- 4 pcs of Clamp
- 1 pc of Handle

OPTIONAL ACCESSORIES

- Cross Grooved Jaws
- "V" Jaws
- Comvbined Jaws
- Step Jaws

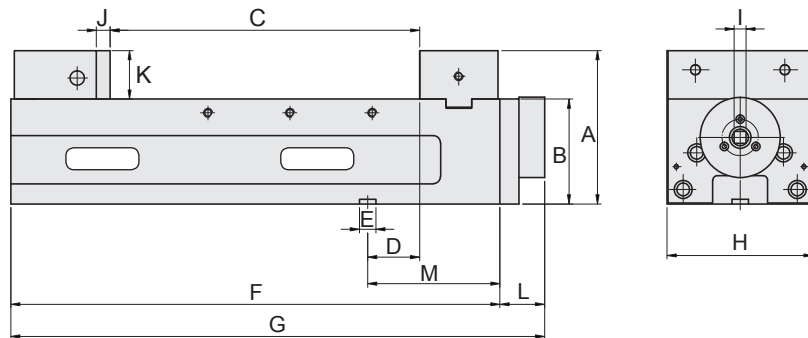

SPECIFICATIONS (Material: FCD 60 Ductile Iron. Hardness: HRC 50°)

Unit: mm

MODEL	A	B	C	D	E	F	G	H	I
HPAQ-II-160F	168	115±0.01	0-300	57±0.02	18	547	596	160	12.7
MODEL	J	K	L	M	Max. Clamping Force			Weight (kg)	
HPAQ-II-160F	15	53	49	145±0.02	5000 kg			70	

MULTI-POWER CNC SUPER VISE (Front-Mounting Type)

PATENTED
M278511
M458489
M287204
M435335
M397304

Model: HPAQ-160F, 200F

- Special MULTI-POWER design enhances clamping force of **0~6000kg**
- It's **ergonomics** for easy reach, thus saves time and prevents back strain
- It possesses all features of HPAQ-Type

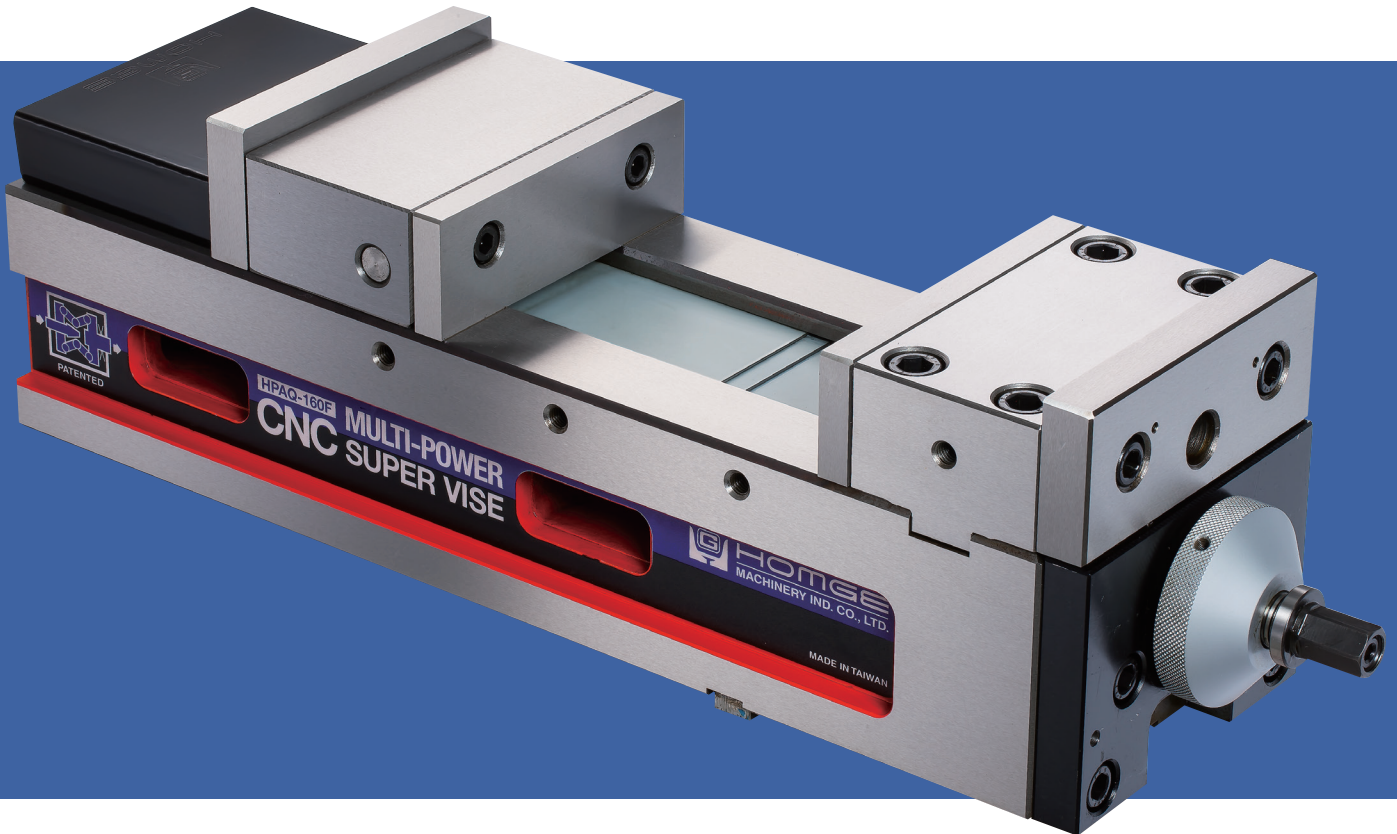

STANDARD ACCESSORIES:

- 2 pcs of Alignment Wedge
- 4 pcs of Clamp
- 1 pc of Handle

OPTIONAL ACCESSORIES

- Cross Grooved Jaws
- "V" Jaws
- Comvbined Jaws
- Step Jaws

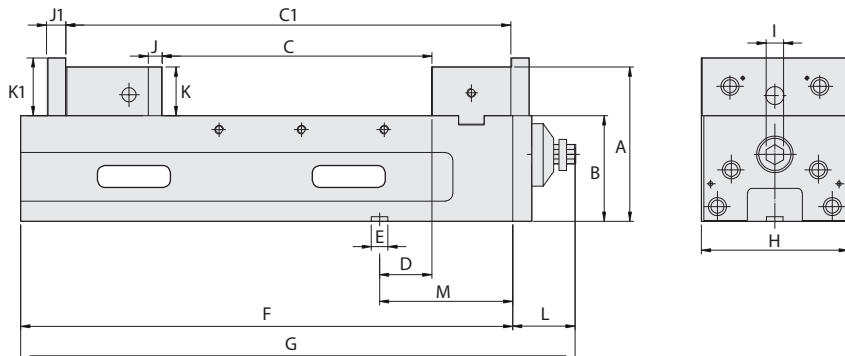

SPECIFICATIONS (Material: FCD 60 Ductile Iron. Hardness: HRC 50°)

Unit: mm

MODEL	A	B	C	C1	D	E	F	G	H
HPAQ-160F	168	115±0.01	0-300	195-490	57±0.02	18	536	637	160
HPAQ-200F	187	120±0.01	0-350	200-570	66±0.02	18	616	715	200
MODEL	I	J	J1	K	K1	L	M	Max. Clamping Force	Weight (kg)
HPAQ-160F	19	15	20	53	63	101	145±0.02	5000 kg	70
HPAQ-200F	19	18	24	66	75	99	168±0.02	6000 kg	120

OPTIONAL ACCESSORIES:

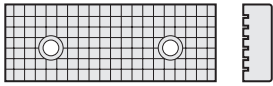

1) Cross Grooved Jaws

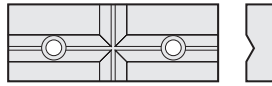

2) 'V' Jaws

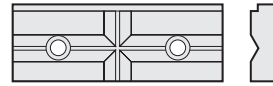

3) Combined Jaws

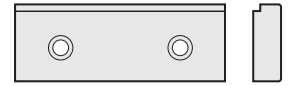

4) Step Jaws

DIMENSIONS

HPAQ-100, 130

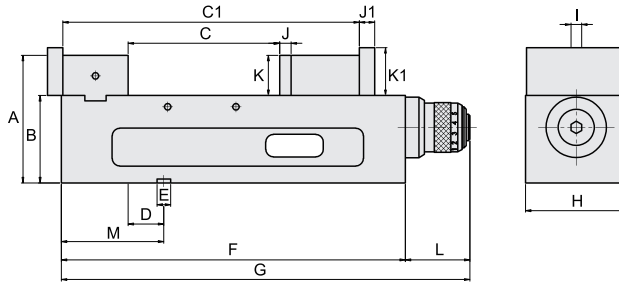

HPAQ - 160, 200, 250, 160L, 200L

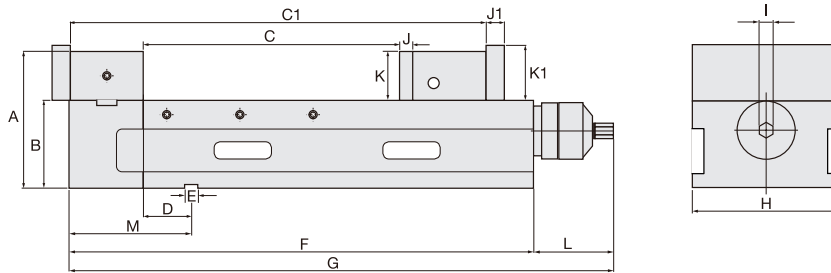

SPECIFICATIONS (Material: FCD 60 Ductile Iron. Hardness: HRC 50°)

Unit: mm

Model	A	B	C	C1	D	E	F	G	H
HPAQ-100	145	105±0.01	0-170	185-350	65±0.02	18	420	507	104
HPAQ-130	163	115±0.01	0-205	195-395	57±0.02	18	470	557	134
HPAQ-160	168	115±0.01	0-300	195-490	57±0.02	18	560	677	160
HPAQ-200	187	120±0.01	0-350	220-570	66±0.02	18	637	754	200
HPAQ-250	187	120±0.01	0-450	220-670	66±0.02	18	746	863	250
HPAQ-160L-400	168	115±0.01	0-400	206-600	57±0.02	18	665	792	160
HPAQ-160L-500	168	115±0.01	0-500	206-700	57±0.02	18	765	892	160
HPAQ-160L-650	168	115±0.01	0-650	206-860	57±0.02	18	925	1042	160
HPAQ-200L-500	187	120±0.01	0-500	220-720	66±0.02	18	806	923	201
HPAQ-200L-600	187	120±0.01	0-600	220-820	66±0.02	18	910	1027	201
HPAQ-200L-850	187	120±0.01	0-850	220-1070	66±0.02	18	1156	1273	201
HPAQ-200L-1140	187	120±0.01	0-1140	220-1360	66±0.02	18	1446	1563	201

Model	I	J	J1	K	K1	L	M	Max. Clamping Force	Weight (kg)
HPAQ-100	14	15	20	40	50	87	145	4000 kg	40
HPAQ-130	14	15	20	48	58	87	145	5500 kg	50
HPAQ-160	19	15	21	53	63	117	145	8000 kg	73
HPAQ-200	19	18	25	66	75	117	168	8000 kg	120
HPAQ-250	19	18	24	66	75	117	168	8000 kg	140
HPAQ-160L-400	19	15	21	53	63	117	145	8000 kg	83
HPAQ-160L-500	19	15	21	53	63	117	145	8000 kg	92
HPAQ-160L-650	19	15	21	53	63	117	145	8000 kg	107
HPAQ-200L-500	19	18	24	66	75	117	168	8000 kg	144
HPAQ-200L-600	19	18	24	66	75	117	168	8000 kg	160
HPAQ-200L-850	19	18	24	66	75	117	168	8000 kg	190
HPAQ-200L-1140	19	18	24	66	75	117	168	8000 kg	217



Factory: No.287, Sec. 1, Shenlin Rd., Daya Dist., Taichung City 428, Taiwan
Tel: 886-4-2567 2057 . 2566 6158 | **Fax:** 886-4-2567 2016 . 2568 6099
E-mail: homge@ms22.hinet.net | **http://www.homge.com.tw**

