



SPINDLES ARE OUR PROFESSION.

**KENTURN**  
健椿工業股份有限公司

一廠  
THE 1ST FACTORY

彰化縣線西鄉彰濱東七路16號  
No.16, East 7 Rd.,  
Chang-Bin Industrial Park,  
Changhua, Taiwan

☎ +886-4-791 0271  
☎ +886-4-791 0272

二廠  
THE 2ND FACTORY

彰化縣線西鄉線工路3號  
No.3, Xiangong Rd.,  
Xianxi Township,  
Changhua, Taiwan

☎ +886-4-791 0688  
☎ +886-4-791 0272

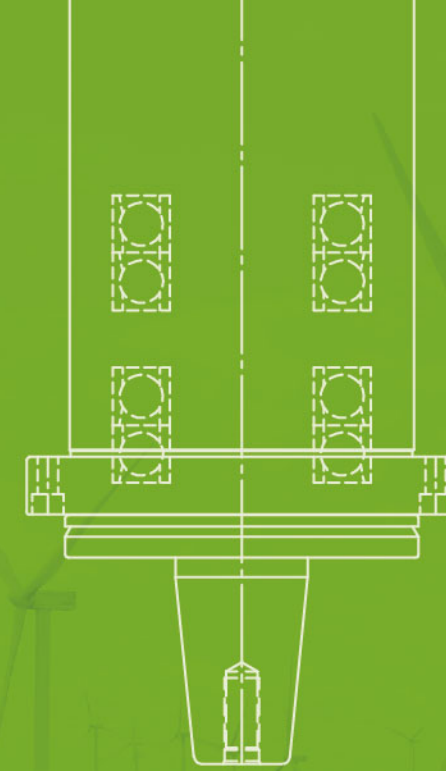
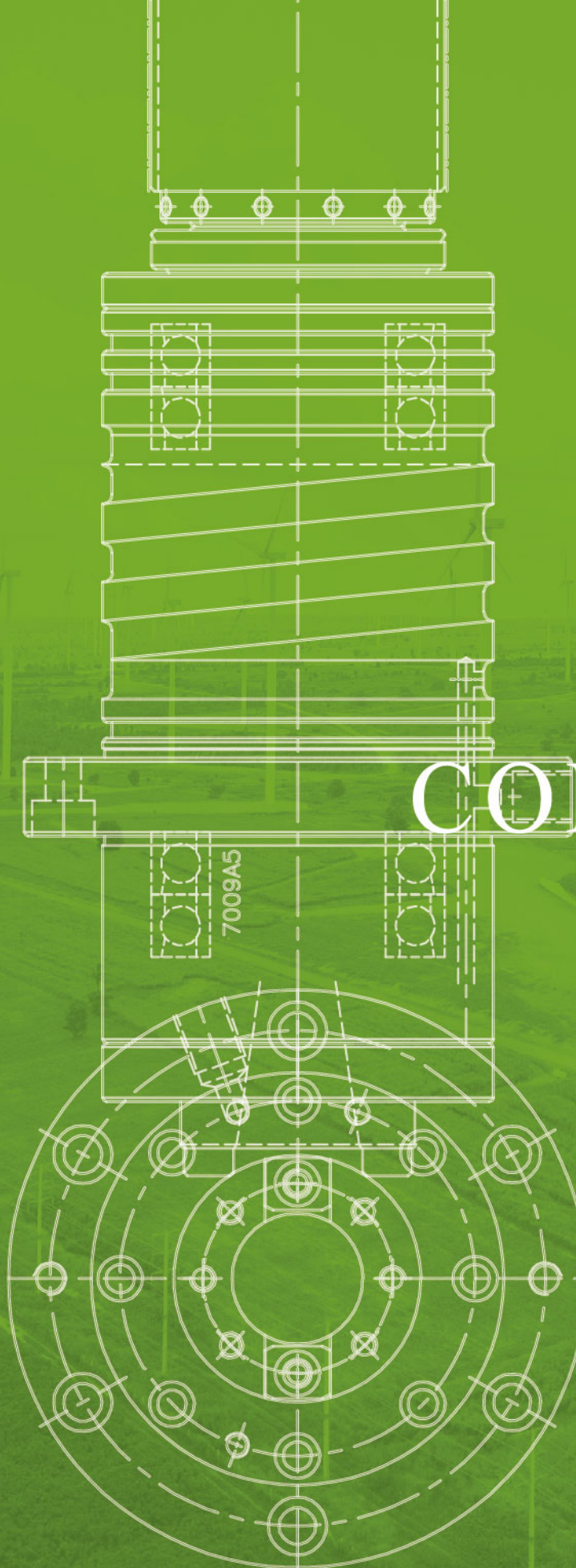

公司簡介

COMPANY PROFILE

[www.kenturn.com.tw](http://www.kenturn.com.tw)



# 「KENTURN」為健椿之唯一品牌 100% 台灣製造

KENTURN is our only brand, 100% made in Taiwan and deserves your trust.

健椿專精於各種機械主軸研發、設計、製造、組裝及銷售。自西元1983年成立迄今，不斷鑽研創新技術與實務，積極提高健椿主軸設計製造團隊的實力。以創新為立基點，健椿主動站在客戶立場提供解決方案，創業初期從一般主軸產品切入市場，繼而開發精密主軸，建立品質的獨特性、提升主軸附加價值，進而生產直結式主軸至精密的內藏式主軸。健椿主軸不僅能夠針對客戶需求量身打造，重視服務品質及效率的企業精神，在售後服務的後續品管依然可見一般，健椿能夠即時幫客戶維修、解決實際生產技術問題，更能有效協助客戶完成生產目標。

Kenturn has been designing, manufacturing, fabricating and marketing machine tool spindles of all kinds since 1983. The company prides itself on intensively studying spindle design and producing innovative technology. It is always improving design and manufacturing teamwork. Kenturn's innovation and initiative guide its planning. In the early days of the industry, the company developed the Kenturn precision spindle, establishing a unique level of quality. The company continued to progress by providing added value spindles, including Direct-Drive and Precision Built-in Spindles. The company's products immediately help customers maintain and resolve technological problems, and assist customers to reach their production goals.



- 2018** ● 6月 股票上櫃掛牌買賣  
Jun. List on Taipei Exchange
- 2016** ● 取得「德國萊因 TUV 企業營運能力」認證  
9月 通過 ISO 50001 能源管理系統認證  
11月 興櫃掛牌交易  
Got " TÜV Rheinland CERTIFIED " Taiwantrade Supplier Verification  
Sep. Got ISO 50001 energy management system certification  
Nov. Trading of Emerging Stocks on the TPEX
- 2015** ● 6月 彰濱二廠完工啟用  
8月 辦理股票首次公開發行  
Jun. Chang Bin 2nd Plant completed and put into production.  
Aug. Initial Public Offering ( IPO )
- 2014** ● 通過CE 認證  
通過ISO 14001 環境管理系統認證  
通過OHSAS 18001 職業安全與衛生管理系統認證  
Got CE certification  
Got ISO 14001 environmental management certification  
Got OHSAS 18001 occupational health & safety management certification
- 2011** ● BIG PLUS 簽約授權認可廠商  
BIG PLUS authorized
- 2008** ● 內藏式雙面磨刀主軸開發  
通過 ISO 9001 品質管理認證  
Made two side built-in cutting tool grinding spindle  
Got ISO 9001 quality management certification
- 2005** ● 彰濱一廠廠房 6,600 m<sup>2</sup> ( 2,000 坪 ) 落成啟用，研發高速台車驅動組合與機器人驅動組合  
Moved to Chang-Bin new factory(6,600 m<sup>2</sup>) and designed high-speed automation system
- 2000** ● 研發 TFT 生產設備零組件及各種主軸標準化  
Made the spindles standardized, and made parts for TFT instruments
- 1997** ● 生產微鑽頭加工主軸與治具  
Made PCB spindles and jigs
- 1994** ● 生產水車專用主軸與工作站定位盤  
Made spindles for rotary and made fixed plate
- 1990** ● 生產CNC綜合加工機主軸、CNC車床主軸、CNC內藏式馬達主軸  
Made spindles for CNC machines, Lathes, and also made built-in milling spindles
- 1985** ● 生產內藏高頻馬達主軸與專用機主軸  
Made built-in spindles and special purposed spindles
- 1983** ● 成立於彰化縣和美鎮，生產量測設備與研磨主軸  
Established in Homei, Changhua, and produced grinding spindles and measuring instruments

## 競爭優勢 | COMPETITIVE ADVANTAGE

### OVER 35 YEARS EXPERIENCE

經營團隊及主要研發人員穩定度高，設計生產經驗得以傳承，多位資深設計工程師都深具學識與實務經驗，不斷鑽研創新技術與實務，積極提高健樁主軸設計製造團隊的實力。

The stability of the management team and major R&D personnel is high, and the design and production experience can be passed down. A number of senior R&D personnel have deep academic and practical experience, constantly delving into innovative technologies and actively improving the strength of the company's design team.

### 90% GRINDING PROCESS MADE INSIDE FACTORY

主軸零件自製率高，利於產品精度提升，有效控制生產品質，並彈性調整生產排程，增加產線靈活度，增加生產自主彈性，有效管控生產成本。

Spindle parts have a high self-made rate, which facilitates the improvement of product accuracy, increases production flexibility, and controls production costs effectively.

### EXPORTED TO OVER 50 COUNTRIES

KENTURN 品牌行銷遍佈世界各地，擁有客戶極高的肯定，產品廣泛運用於航太、汽車、機車、生物科技、木工機、造船、醫學設備、電子半導體製造工業、IT 產業行業。

The KENTURN brand is sold all over the world and has a high level of customer recognition. The products are widely used in aerospace, automotive, locomotive, biotechnology, woodworking machines, shipbuilding, medical equipment, electronic semiconductor manufacturing, and IT industries.

### OVER 2400 SET SPINDLE CAPACITY PER MONTH

加強內藏式主軸製造組裝技術，以達到主軸高速化組裝需求，符合『自動化』與『量化』的生產能力，並持續增加高階精密設備，以提供最優質產品為職志。

Strengthen the manufacturing and assembly technology of built-in motor spindles to meet the requirements for high-speed assembly of spindles, and meet the production capacity of "automation" and "quantitative", and continuous increase in high-end precision equipment to provide the highest quality products.

### OVER 4000 KINDS OF SPINDLE WERE MADE

提供少量多樣及客製化設計生產服務，即時因應客戶需求，為客戶量身打造專屬精密主軸，建立緊密之合作關係。

Provide a small amount of diverse, customized design and production services. Establishing close cooperation relationships with customers.

### HEADQUARTER OVER 50000 m<sup>2</sup>

兩個生產基地佔地面積超過5公頃，一廠為精密主軸組裝製造，二廠則是精密主軸零件的加工生產及精密刀具生產基地。

Two production plants cover an area of more than 5 hectares. The first plant is a precision spindle assembly manufacturing plant. The second plant is a precision spindle component processing and production and precision tool production base.

## 公司設備 | EQUIPMENTS

最先進檢測設備，並有精確裝備技術，產品完成後經可靠度測驗，使顧客安心無慮。我們有最先進的機械加工設備，結合歐美加工技術再加上幾十年加工技術經驗，使我們的產品更為專精。

Using state of the art instruments. Precision assembly techniques must pass High-Reliability test. The most advanced machinery finishing equipment featuring the best of western technology and own decades of finishing and manufacturing experience.



## 技術服務 | TECHNICAL SERVICES

### 客製主軸 | CUSTOMIZATION SPINDLE

主軸是主宰機械性能的關鍵零組件！  
健樁投入各式主軸研發製造已逾40年經驗，  
協助您改善加工設備性能最佳良伴！

Spindle is dominated by the mechanical properties of the key components!  
Kenturn spindle into all kinds of development, and manufacturing for more than 40 years of experience.

Help you improve the performance of processing equipment best companion!

### 主軸維修 | SPINDLES REPAIR

提供客戶最佳解決方案！  
提供國內外各式機械主軸服務！

Providing customers with the best solution.  
Provide a variety of domestic and foreign machine tool spindle service.

## 主軸規格 | SPINDLE SPECIFICATION

### 皮帶銑床主軸規格表 | CNC MACHINE CENTER SPINDLE-BELT DRIVE

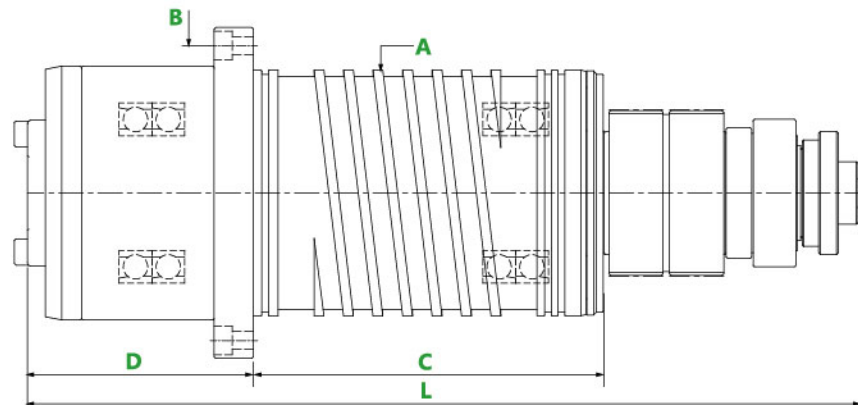

Type	Spindle Taper	Max. speed (rpm)	Locking hole (mm)	Dimensions (mm)			
			B	A	C	D	L
MV0910D	BT30	15000	6-Ø14X9L, 6-Ø9 thru., PCD Ø120	Ø100	124	100	300
KL1212K-A	BT40	12000	6-Ø14X9L, 6-Ø9 thru., PCD Ø146	Ø120	170	126	424.6
KCA1410	BT40	12000	8-Ø17.5X11L, 8-Ø11 thru., PCD Ø180	Ø150	214	138	509
KC1508	BT50	6000	8-Ø17.5X11L, 8-Ø11 thru., PCD Ø180	Ø150	227	185	607
MC1806	BT50	6000	6-Ø20X13L, 6-Ø13 thru., PCD Ø220	Ø190	210	200	648
MC1806S	BT50	6000	6-Ø20X13L, 6-Ø13 thru., PCD Ø220	Ø190	276	94	591

### 直結主軸規格表 | CNC MACHINE CENTER SPINDLE-DIRECT DRIVE

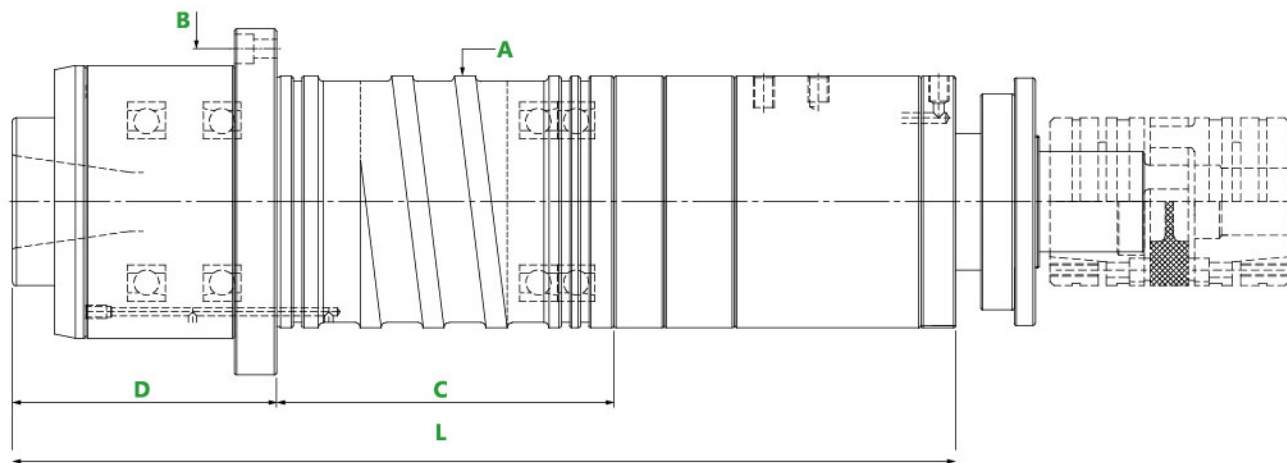

Type	Spindle Taper	Max. speed (rpm)	Locking hole (mm)	Dimensions (mm)			
			B	A	C	D	L
KDS0915	BT30	15000	4-Ø14X10L, Ø9 thru., PCD Ø120	Ø100	122	50	354
KDS0915B	BT30	15000	6-Ø14X9L, 6-Ø9 thru., PCD Ø120	Ø100	122	123	427
KDS1212	BT40	15000	6-Ø14X9L, 6-Ø9 thru., PCD Ø146	Ø120	161	126	540
KDS1312-A	BT40	15000	8-Ø17.5X11L, 8-Ø11 thru., PCD Ø180	Ø150	190	138	556
KDS1512C	BT50	8000	8-Ø17.5X11L, 8-Ø11 thru., PCD Ø180	Ø150	220	165	660
KDS1810D	BT50	10000	6-Ø20X13L, 6-Ø13 thru., PCD Ø220	Ø190	226.5	202	671
KDS1810A	BT50	10000	6-Ø25X17L, 6-Ø17 thru., PCD Ø220	Ø190	245	90	611
KDS2006E	BT50	10000	8-Ø20X13L, 8-Ø13 thru., PCD Ø222	Ø190	320	80	791

### 車床主軸規格表 | CNC TURNING SPINDLE

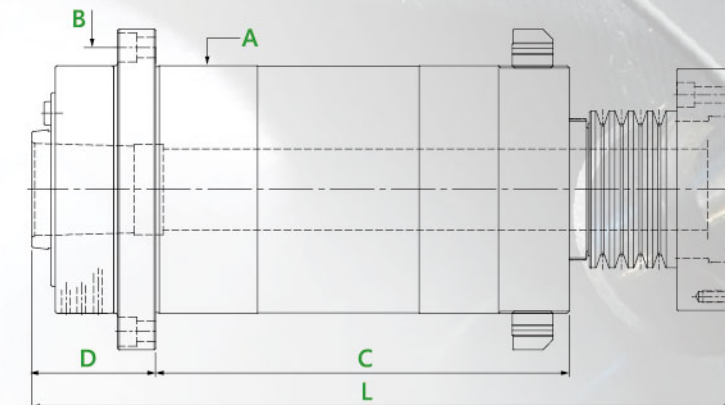

Type	Spindle Nose	Max. speed (rpm)	Locking hole (mm)	Dimensions (mm)			
			B	A	C	D	L
Belt Drive Horizontal							
KT1208	A2-4	5000	4-Ø11X7L, Ø6.6 thru., PCD Ø132.5	Ø118	193	50	329
KT1406D	A2-4	6000	8-Ø14X9L, 8-Ø9 thru., PCD Ø170	Ø150	226	79.1	454.1
KT7006G	A2-4	6000	8-Ø14X9L, Ø9 thru., PCD Ø170	Ø150	273	80	454
KT1605	A2-5	6000	6-Ø20X13L, 6-Ø14 thru., PCD Ø195	Ø170	299	87	561
KT1605I	A2-5	6000	6-Ø20X13L, 6-Ø14 thru., PCD Ø195	Ø170	299	87	557
KT20045	A2-6	4500	8-Ø14X13L, 8-Ø9 thru., PCD Ø224	Ø200	306	94.3	559.3
KT2004A	A2-6	4000	8-Ø14X9L, 8-Ø9 thru., PCD Ø224	Ø200	291	94.3	557.3
KT2204	A2-6	4000	8-Ø14X9L, 8-Ø9 thru., PCD Ø224	Ø200	306	94.3	559.8
KT26025C	A2-8	3000	8-Ø14X9L, Ø9 thru., PCD Ø280	Ø260	295	96	638
KT2803A	A2-8	2500	8-Ø14X9L, 8-Ø9 thru., PCD Ø280	Ø260	295	96	638
KT36015	A2-11	1500	8-Ø19X13L, 8-Ø13 thru., PCD Ø360	Ø340	440	108	850
KT4401	A2-15	1200	8-Ø31X22L, 8-Ø22 thru., PCD Ø460	Ø410	600	152	1054
Belt Drive Vertical							
KTV1804	A2-6	4000	6-Ø17X15L, Ø11 thru., PCD Ø210	Ø180	373	93	578
KTV26022	A2-8	2250	6-Ø19X13L, Ø13 thru., PCD Ø300	Ø270	338	113	620.5
KTV3402	A2-11	1500	6-Ø26X18L, 6-Ø17 thru., PCD Ø390	Ø340	414	138	713.5
KTV44015	A2-11	1500	8-Ø31X22L, 8-Ø22 thru., PCD Ø480	Ø410	494	153	803.5

## 磨床及專用機主軸 | CNC GRINDING SPINDLE & SPECIAL MACHINE SPINDLE



HP0830



HP1602



PS9059



GVB0520



GV1002R



KJ100