

ARISTECH® ISO-9001 CE

SAMPLE OF DRILLING:



GENERAL FEATURES:

- 1.Machines are designed in compliance with EC MACHINERY DIRECTIVE 89/392/EEC and EN 292 CODES for technical and safety aspects.
- 2.Being for COMPACT DESIGN and thus saving space. equipped with 2(or3) axes DIGITAL READOUT system for easy positioning (optional instrument).
- 3.The LSD-25,30,35,65 provide Z-2 axis travel for large mould operating.
- 4.Whole digitize operate panel. And 10 sets of random access of parameters in memory.
- 5.It is able to drill the deep holes on the materials such as stainless steel, hard metal alloy, copper, aluminum, etc.
With diameter from 0.30mm (0.0118") to 3.0mm(0.118").
- 6.Use clean water for dielectric fluid, and with resing filtering system. Which is unharmpful to human body.

STANDARD ACCESSORIES:

- 1.1 Pc electrode drill chuck $\varnothing 0.3$ - $\varnothing 3.0$ mm.
- 2.1 Pc electrode guide $\varnothing 1.0$ mm.
- 3.10 Pcs electrode pipe $\varnothing 1.0$ mm.
- 4.1 set tool box & kits.
- 5.1 unit filter bucker.

OPTIONAL ACCESSORIES:

- 1.Digital Read Out & scales.
- 2.Electrode guide $\varnothing 0.2$ - $\varnothing 3.0$ mm(0.1 mm per step).
- 3.Electrode pipe $\varnothing 0.2$ - $\varnothing 3.0$ mm (0.1mm per step).
- 4.Precision electrode 3-JAW chuck.
- 5.Air compressor.
- 5.Cutting path dry run & display.
- 6.Machining interrupt and return.
- 7.Automatic electrode wear rate compensation.
- 8.Diagnostic function (alarm & warning display).

DNC-35,50.CNC FUNCTION:

- 1.Automatic edge & center point finding and start point return.
- 2.DXF edit (CAM, Graphic transfer file).
- 3.Chinese / English display.
- 4.Mirror image in X, Y axes and copy function.

DNC STANDARD ACCESSORIES (With 16-ATC Electrode Tube Changer.) :

- 1.Electrode ER 16 Colects From $\varnothing 0.7$ mm To $\varnothing 1.0$ mm,
But 16 pieces in one size Only.
- 2.Electrode Guide $\varnothing 1.0$ mm.
- 3.Electrode Tube $\varnothing 1.0$ mm.
- 4.Tools Box & Kits.
- 5.Halogen Work Lamp.
- 6.Filtering unit.
- 7.XYZ Axes In AC Servo Motors & W-Axis by AC Servo Motor.
- 8.15" TFT LCD Displayed And 16 Pieces Electrode Tubes Changer System.

DNC OPTIONAL ACCESSORIES (With 16-ATC Electrode Tube Changer.) :

- 1.Electrode Guider $\varnothing 0.3$ to $\varnothing 3.0$ mm. Per 0.1mm One size one piece.
- 2.Electrode Copper Tube $\varnothing 0.3$ mm, 300mmL.
- 3.Electrode Brass Tube $\varnothing 0.4$ to 3.0mm, 400mmL. Per 0.1mm one size.
- 4.Metal Net Water Filter.
- 5.Electrode Collect ER-16 & Nut ($\varnothing 0.4$ - 0.6 , 0.7 - 1.0 mm) 2 Sizes/2 sets.
- 6.Electrode Collect ER-16 & Nut ($\varnothing 1.1$ - 2.0 , 2.1 - 3.0 mm) 2 Sizes/2 sets.
- 7.Ion Exchanging Dielectric Stainless Steel Tank, Capacity 320 Liters.



DNC-35,50.
CNC CONTROLLER PANEL.

ARISTECH® ISO-9001 CE



ISO-9001 CERTIFICATION



CE MARK CERTIFICATION



LIEN SHENG MECHANICAL & ELECTRICAL CO., LTD.
No. 225, Jen Hwa Road, Ta-Li Dist., 41278
Taichung City, TAIWAN, R.O.C.
TEL:886-4-2491-9588 · FAX:886-4-2491-5275.
URL:www.aristech.com.tw
E-mail:sales@aristech.com.tw

LSD-EV10-1307-1500



ARISTECH®

LSD ZNC & CNC DRILL E.D.M.



LSD-20

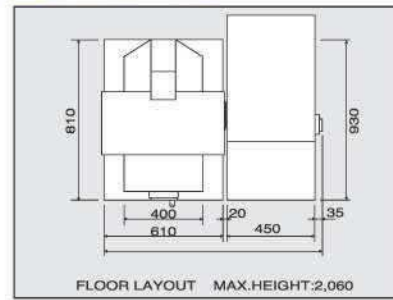

LSD-25

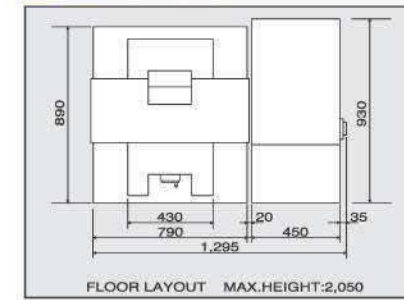

LSD-30

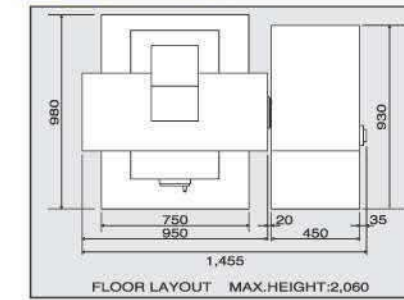

LSD-35

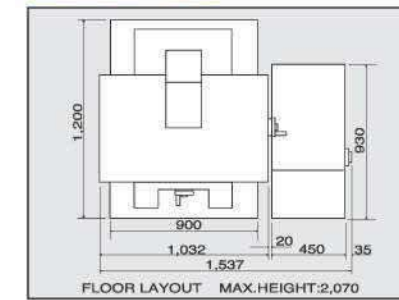

LSD-65

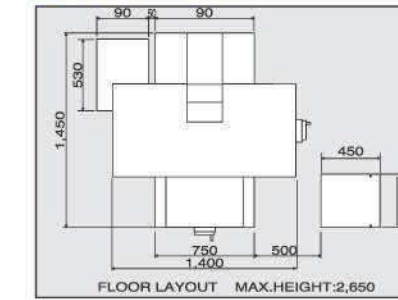

DNC-35

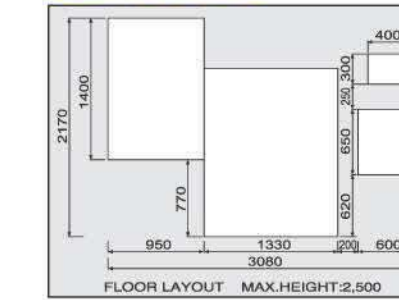

DNC-50

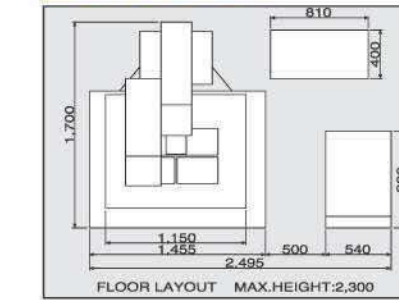

MACHINE UNIT:

SPECIFICATIONS	SERIES NO.	LSD-20	LSD-25	LSD-30	LSD-35	LSD-65
Work table (WxD)	mm/inch	450x210 (17.7x8.3)	450x210 (17.7x8.3)	600x300 (23.6x11.8)	600x300 (23.6x11.8)	700x450 (27.6x17.7)
Work tank (WxD)	mm/inch	790x490 (31.1x19.3)	790x490 (31.1x19.3)	860x560 (33.8x22)	1030x650 (40.6x25.6)	1410x740 (55.5x29.1)
X axis travel	mm/inch	300 (11.8)		350 (13.8)	400 (15.7)	650 (25.6)
Y axis travel	mm/inch	200 (7.9)		250 (9.8)	300 (11.8)	450 (17.7)
Ram servo travel Z1 Axis	mm/inch	330 (13.0)				
Workhead travel Z2 Axis	mm/inch	0 (0)	200(7.9)		200 (7.9)	350 (13.8)
Handwheel travel W-Axis	mm/inch	150 (5.9)				
Max.workpiece weight	kgs/lbs	100 (220)	300 (660)			500 (1100)
Electrode pipe diameter	mm/inch	Ø0.2-Ø3.0(0.0078-0.118)				
The max.heigh of workpiece	mm/inch	50-200 (2-7.9)	50-400 (2-15.8)	50-400 (2-15.8)	50-400 (2-15.8)	220-720 (8.7-28.4)
Outside dimension	mm/inch	1040x1060x2000 (40.9x41.7x78.4)	850x900x1980 (33.5x35.5x78)	1040x1140x2100 (40.9x44.9x82.7)	1200x1200x2050 (47.2x47.2x80.7)	1490x1365x2110 (58.7x53.8x83.1)
Packing dimension	mm/inch	1230x1170x2220 (48.4x46.1x87.4)	1110x1305x2230 (43.7x51.4x87.8)	1185x1245x2240 (46.7x49x88.2)	1560x1340x2252 (61.4x52.8x88.7)	1652x1610x2240 (65x63.4x88.2)
Net weight	kgs/lbs	750 (1650)	750 (1650)	900 (1980)	900 (1980)	1500 (3300)

POWER SUPPLY UNIT:

SPECIFICATIONS	SERIES NO.	30A
Normal current	A	30
Total power input	KVA	3.5
Circuit system		Power MOS FET
Control axis		Z AXIS
Control system		10 steps cutting data
Display type		LED Displayed
Coordinate system (Positioning commands)		-
Jog speed		Manual
Least input increment (X,Y axes)	mm/inch	0.005(0.0002")when with linear scales
Outside dimension	mm/inch	1100x540x850(43.3x21.3x33.5)
Packing dimension	mm/inch	1100x540x850(43.3x21.3x33.5)
Net weight	kgs/lbs	170(374)

*Optional current 50A is available.
*Specifications are subject to change without notice.

MACHINE UNIT:

SPECIFICATIONS	SERIES NO.	DNC-35	DNC-50
Work table (LxW)	mm/inch	600x350 (23.6x13.8)	700x450 (27.6x17.7)
Work tank (LxWxH)	mm/inch	1000x650x100 (39.4x25.6x3.9)	1160x935x100 (45.7x36.8x3.9)
X axis travel	mm/inch	400 (15.7)	650 (25.6)
Y axis travel	mm/inch	300 (11.8)	450 (17.7)
Ram servo travel Z	mm/inch	250 (9.8)	
Work head Sparking travel W	mm/inch	380 (14.9)	
Max. work piece weight	kgs/lbs	250 (550)	300 (660)
Electrode pipe diameter	mm/inch	Ø0.3-Ø3.0 (0.0118-0.118)	
Mini./Max. height of workpiece	mm/inch	50-300 (1.9-11.8)	
Outside dimension (LxWxH)	mm/inch	1100x1300x2300 (43.3x51.2x90.6)	1500x1700x2300 (59x67x90.6)
Packing dimensions(LxWxH)	mm/inch	1870x1450x2230 (73.7x57.1x87.8)	1590x1790x2230 (62.6x70.5x87.8)
Net weight	kgs/lbs	1200 (2640)	1900 (4180)

POWER SUPPLY UNIT:

SPECIFICATIONS	SERIES NO.	DNC-30A
Normal current	A	30
Total power input	KVA	3.5
Circuit system		Power MOS transistor
Control axis		X, Y, Z(fast positioning)
Control system		32 bit CPU, CF Card, close loop, linear scales & encoder feed back system
Display type		12" TFT touch screen
Coordinate system (Positioning commands)		Absolute/Incremental
Least input increment(X,Y axes)	mm/inch	0.001 (0.00004")
Outside dimension	mm/inch	540x800x1700 (21.3x31.5x67)
Packing dimension	mm/inch	790x990x1970 (31.1x39.0x77.6)
Net weight	kgs/lbs	200 (440)

*Optional current 50A is available.
*Specifications are subject to change without notice.