



No.96, Ln. 191, Daming Rd., Shengang Dist.,  
Taichung City 429, Taiwan  
T / +886-4-2524 9998  
F / +886-4-2524 7698  
guan.yu168@msa.hinet.net  
www.grinder-grima.com



**KG-350SR / 410SR / 600SR**

# KG-350SR

## Perfect match for Linear way and box way

### CNC Steady Rest Internal Compound Grinding Machine

Single grinding spindle+steady rest  
Max grinding length up to 350mm  
Full splash guard  
Fanuc controller  
X, Z axis stroke 500/700mm



#### ▪ X axis

Wide span design with rigid roller type linear way  
Double linear ways with 6 blocks to make sure axial rigidity and stability.

#### ▪ Z axis

With 1 V 1 Flat box way design and non-stop oil supplying system for rails to make sure grinding straightness and lower friction coefficient during movement.

#### ▪ Spindle

Sleeve type rigid spindle

#### ▪ Air floating sliding way

Easy to move workhead upon length of workpieces

#### ▪ Steady rest

Suitable for long workpiece and provides stability during grinding.

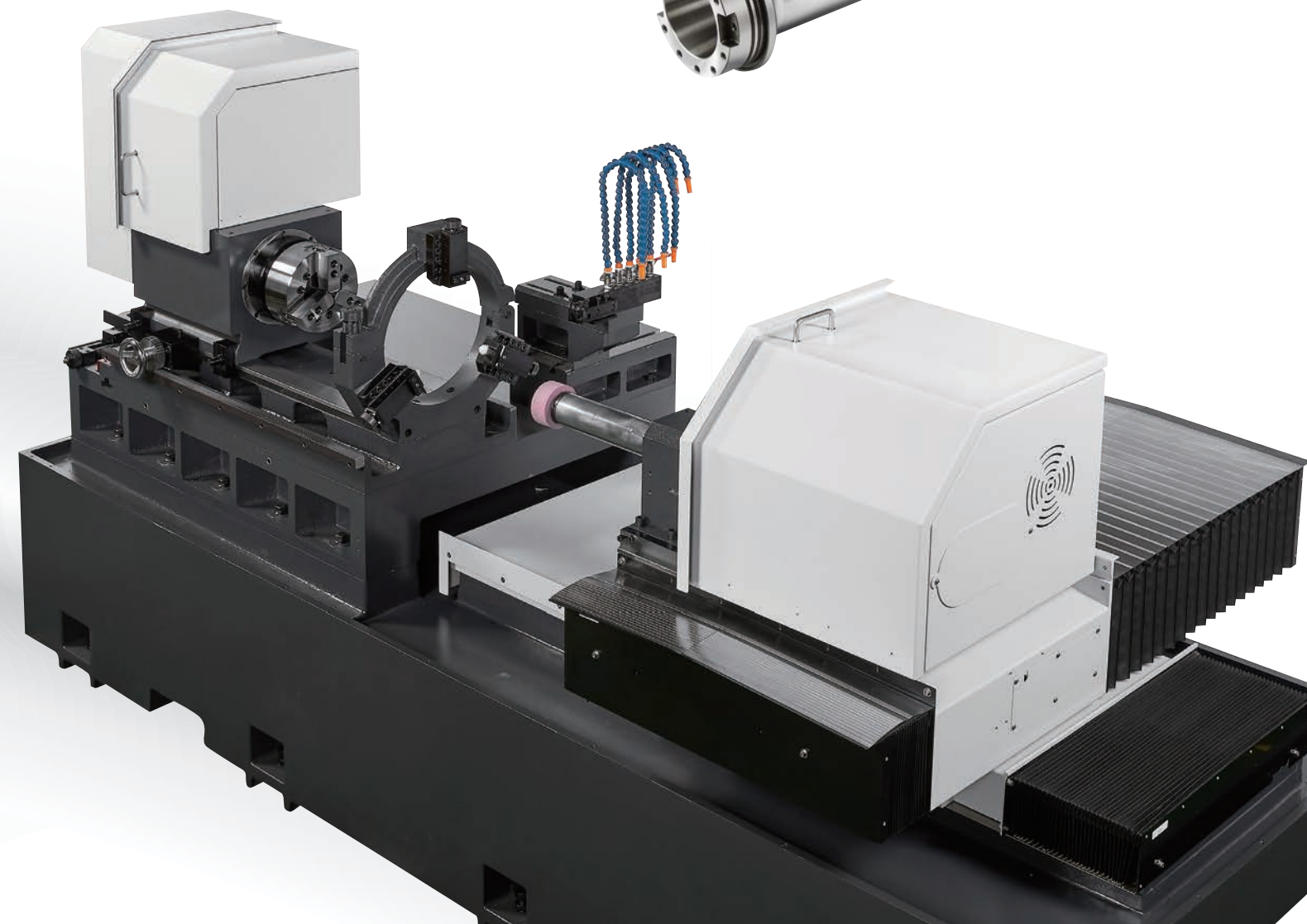



# KG-410SR

## CNC Steady Rest Internal Compound Grinding Machine

Dual grinding spindle+steady rest  
Max grinding length up to 410mm  
Full splash guard  
Fanuc controller  
X, Z axis stroke 650/550mm



### ▪ X axis

Wide span design with rigid roller type linear way  
Four linear ways with 12 blocks to make sure axial rigidity and stability.

### ▪ Z axis

With 1 V 1 Flat box way design and non-stop oil supplying system for rails to make sure grinding straightness and lower friction coefficient during movement.

### ▪ Spindle

A2-6 Sleeve type rigid spindle

### ▪ Air floating sliding way

Easy to move workhead upon length of workpieces  
Sliding way angle 0°~15°

### ▪ Steady rest

Suitable for long workpiece and provides stability during grinding.

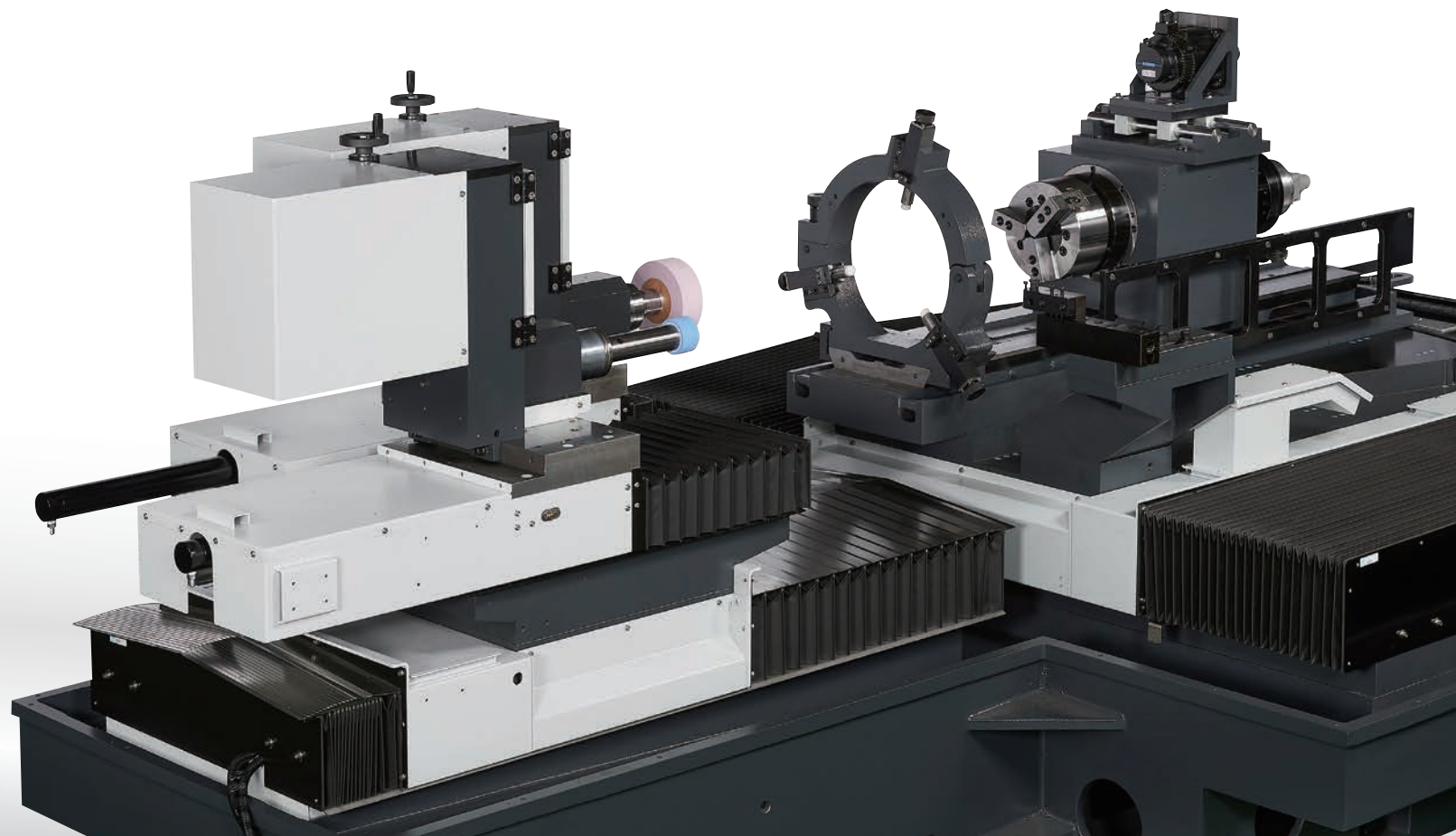
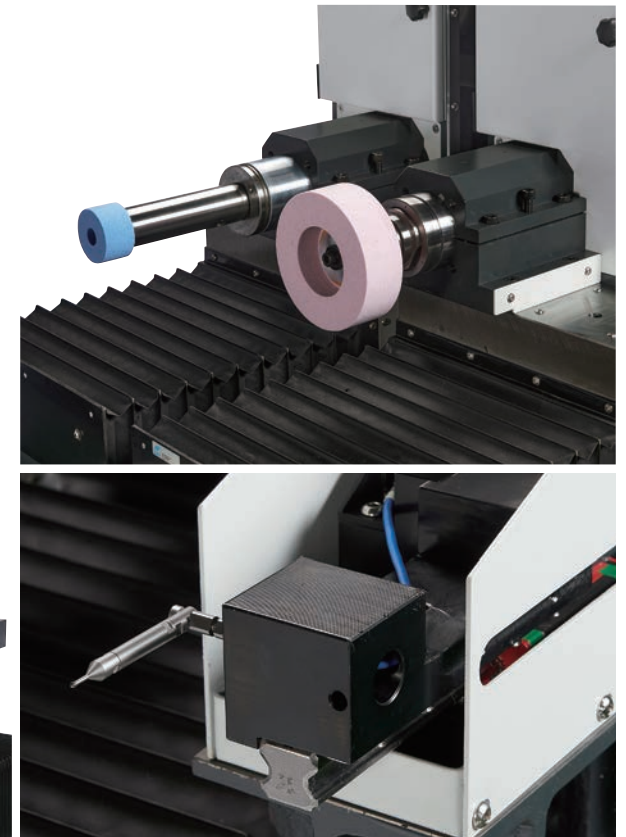



# KG-600SR

## CNC Steady Rest Internal Compound Grinding Machine

Dual grinding spindle+steady rest  
Max grinding length up to 400mm  
Full splash guard  
Fanuc controller  
X, Y, Z axis stroke 800/450/450mm



**X** axis

- » Rigid roller type linear way, four linear ways with 12 blocks to make sure axial rigidity and stability.
- » With high rigidity A2-6 taper spindle. This spindle provides excellent radial rigidity, stable thermal, minimum heat deformation, and high dynamic accuracy to guarantee absolutely grinding quality.
- » Air floating sliding design, easy to move workhead upon length of workpieces.
- » Steady rest, suitable for long workpiece and provides stability during grinding.



**Y & Z** axis

- » Belt type grinding spindle with diameter Ø90mm.
- » Available to change into different speed, which greatly increase grinding efficiency upon various workpieces.
- » With air floating sliding way design, easy to adjust position upon needs.

UNIQUE AND CREATIVE DESIGN

**Y** axis

INDEPENDENT ANGLE ADJUSTMENT

Thinking from client, technology innovation from past. In past, standard taper grinding is with 2 axis simultaneous moving, it will cause friction on ball screw after long term usage and losing its accuracy. To give an ideal solution for client, we innovate an independent angle adjustment system for Y axis to guarantee stability and accuracy of taper grinding.





# KG-350SR | KG-410SR | KG-600SR

					STANDARD ACCESSORIES	KG-350SR	KG-410SR	KG-600SR
Working Capacity	Grinding dia, range Max, grinding depth	Ø 4 ~ Ø 320 mm 350 mm	Ø 4 ~ Ø 320 mm 410 mm	Ø 4 ~ Ø 320 mm 400 mm				
Controller System	Controller	FANUC 0i-TF	FANUC	FANUC				
Workhead	Spindle speed	0 ~ 1000 rpm	0 ~ 1000 rpm	0 ~ 1000 rpm	CNC Controller	●	●	●
	X-axis feed rate/ max. stroke	8 M/min / 500 mm	8M/min / 650 mm	8 M/min / 800 mm	Inverter for X-axis workhead motor	●	●	●
	X-axis minimum display unit	0.0001 mm	0.0001 mm	0.0001 mm	Inverter for Y-axis grinding spindle motor			●
	Swiveling angle	0° ~+15°	-5° ~+15°	0° ~+10°	Inverter for Z-axis grinding spindle motor	●	●	●
Worktable	Y-axis & Z-axis feed rate	Z : 6 M/min	Z : 6 M/min	10/10 M/min	Inverter for Z2-axis grinding spindle motor		●	
	Y-axis & Z-axis max. stroke	Z : 700 mm	Z : 550 mm	450+200/ 450+200 mm	Y-axis grinding spindle			●
	Y-axis & Z-axis minimum display unit	Z : 0.0001mm	Z : 0.0001mm	0.0001 / 0.0001 mm	Z-axis grinding spindle	●	●	●
	Y-axis swiveling angle	-	-	0° ~+10°	Z2-axis grinding spindle		●	
	Distance from spindle center to the ground	1100 mm	1070 mm	1100 mm	Hydraulic chuck	●	●	●
	Swing of working Table	Ø 380 mm	Ø 380 mm	Ø 380 mm	Hydraulic cylinder	●	●	●
Hydraulic System	Oil Tank Capacity	30 L	40 L	30 L	Tricolor alarm lamp	●	●	●
Cooling System	Coolant Tank Capacity	400 L	400 L	380 L	Working lamp	●	●	●
Motor	Hydraulic motor	0.75 Kw (1HP)	1.5 Kw (2HP)	0.75 Kw (1HP)	Tool box	●	●	●
	Coolant pump motor	0.75 Kw (1HP)	0.37 Kw (1/2HP)	Machine : 0.37 Kw (1/2HP) Base : 0.37 Kw (1/2HP)	Automatic lubricator	●	●	●
	X-axis & Y-axis & Z-axis servomotor	X : 2.5 Kw / Z : 2.5 Kw	X : 2.5 Kw / Z : 2.5 Kw	X : 2.5 Kw / Y : 2.5 Kw / Z : 2.5 Kw	Coolant tank and pump	●	●	●
	Grinding wheel motor (kw)	Z : 4.0 , (5HP)	Z: 2.2 , (3HP)	Y: 4.0 , (5HP)	Paper filter	●	●	●
Others	Workhead motor	- 1.8Kw(Brushless Servo)	Z2: 2.2 , (3HP) 1.8Kw(Brushless Servo)	Z: 4.0 , (5HP) 1.8 Kw (Brushless Servo)	Magnetic separator	●	●	●
	Automatic lubricator	-	4 L	4L	Hydraulic tank and pump	●	●	●
	Machine dimension (LxWxH) -including accessories	4300 x 2500 x2050 mm	4200 x 3100 x2100 mm	3500 x 3150 x1960 mm	Internal heat radiation system inside cabinet	●	●	●
	Machine Weight	7500 kg	8000 kg	8300 kg	Diamond Dresser	●	●	●
					Foundation bolts and blocks	●	●	●
					Mechanical, electrical operation manuals	●	●	●
					Fully-enclosed cover	●	●	●
					Semi-enclosed cover	-	-	

\* Specifications and design features are subject to change without notice.



# MACHINE LAYOUT

350SR

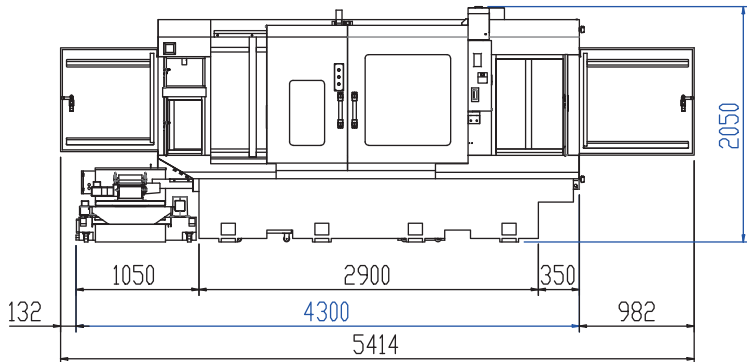
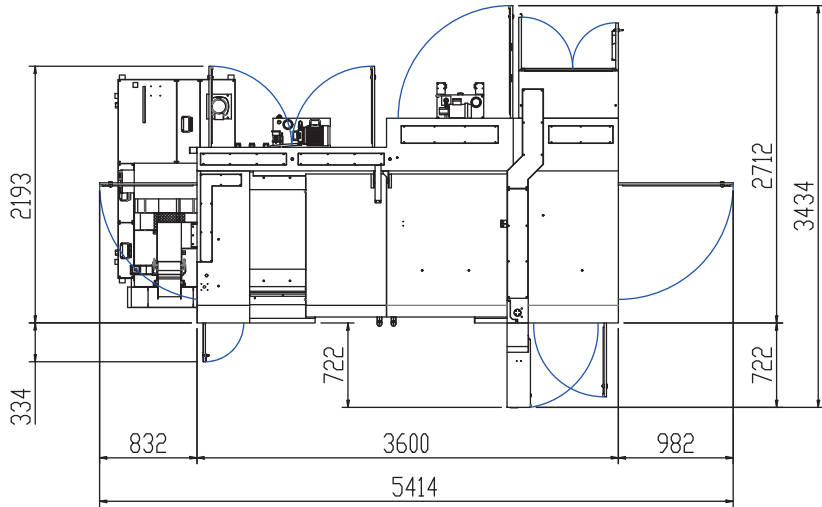
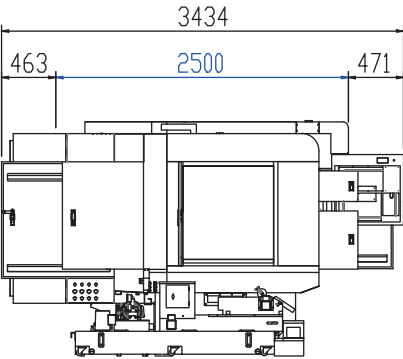

410SR

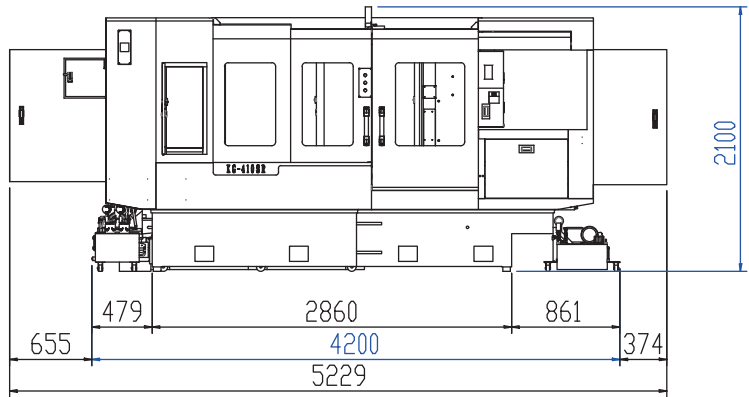
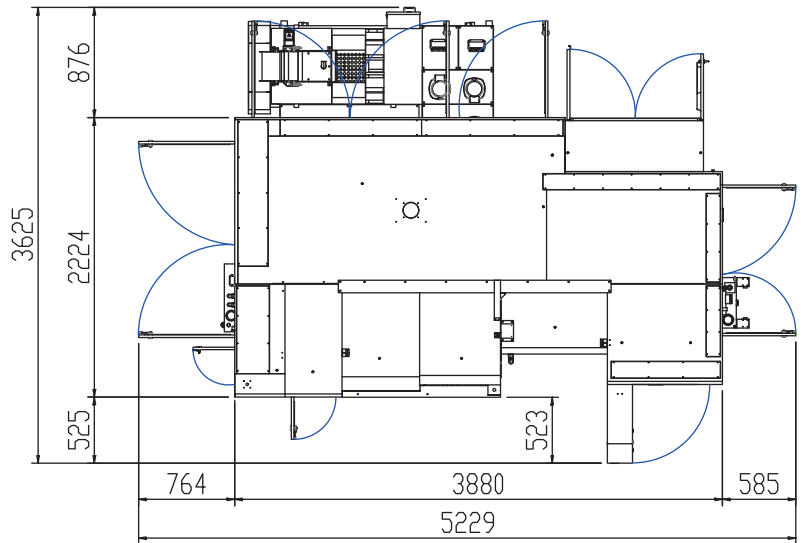
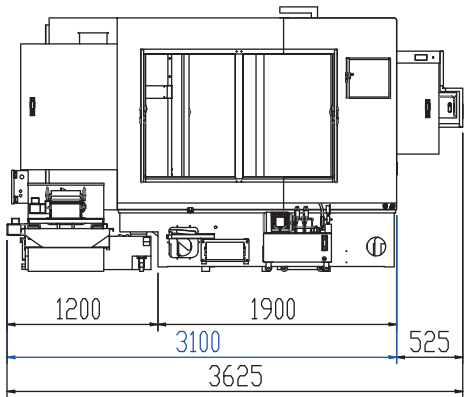

600SR

