

## User Guide

### Instructions :

1. Put stop moving bar into one of the X, Y, and Z hole, depending on the size of the processing items. Rotate the handle till it clip the workpiece.
2. Knock slightly on the handle to switch to pressure increase filling with the strength and rotate to the scale between point a and point b. (See Picture A). Do not exceed point b.

### Oil Filling:

1. Loose the screw of the upper lid and remove the stem. (See picture A)
2. Loose the screw (12) (See picture B)
3. Loose the (5) hydraulic cylinder counterclockwise.
4. Draw the cylinder (41) and fill the hydraulic oil. Insert the cylinder enclosed with the guaranty first and draw it out. Then insert cylinder (41) This is how you fill the oil. Finally you put them together in sequence.

### If open the jaw excessively (Graph A)

1. Loose the dustproof screw which on sub screw rod.
2. Tight the change screw which appended with Guaranty.
3. Circle around the sub screw rod 5 times in clockwise.
4. Then, put the dustproof screw replace the change screw.

Graph A 單位 : mm

	X	Y	Z
4"	0-56	55-114	113-170
5"	0-73	72-146	145-220
6"	0-100	99-200	199-300
8"	0-100	99-200	199-300

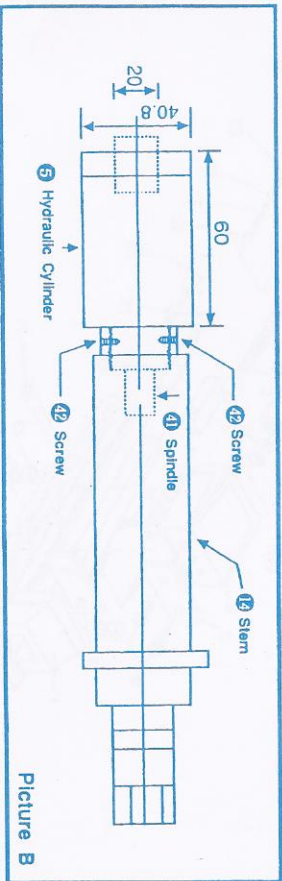
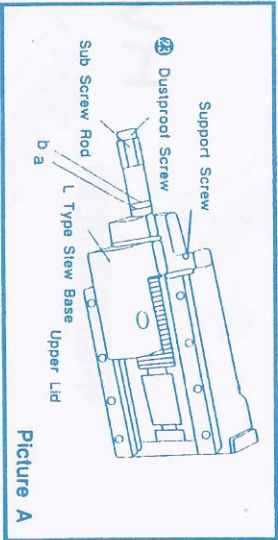

Specifications	4"	5"	6"	8"
a Scale Line	1500kgf	2500kgf	3000kgf	5000kgf
b Scale Line	2500kgf	3500kgf	4500kgf	8000kgf

## TILTING HYDRAULIC MACHINE VISE

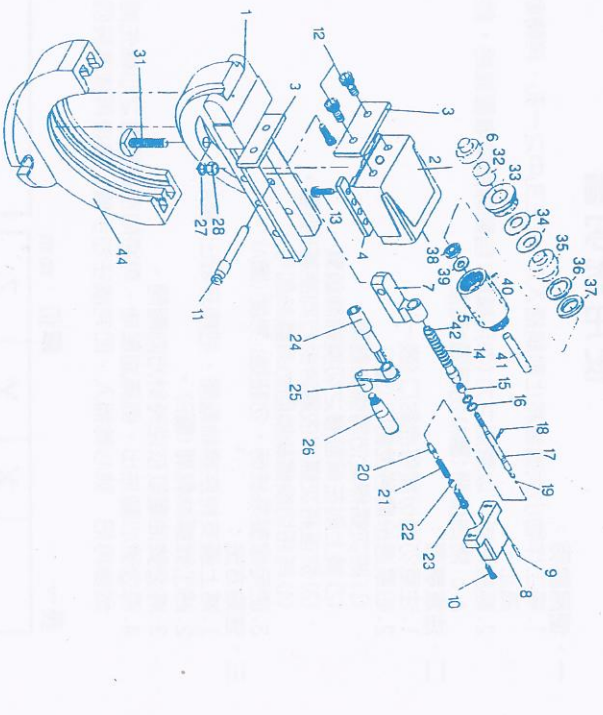

## HYDRAULIC MACHINE VISE

